

# SUBMITTAL SHEET

www.anemostat-hvac.com

1-1/2" SLOT WIDTH

**FLUSH FRAME (W1)**
**PRODUCT FEATURES**

- Adjustable volume and pattern controllers
- Flush mounting frame
- Hardware package includes duct mounting brackets & screws, and alignment strips (where applicable)
- Anemostat Model AD plenums are ordered and shipped separate from the diffusers
- Nominal Length is the order size
- Flush end caps are removable

**CONSTRUCTION FEATURES**
**Material:** Extruded Aluminum

**Finish:**

- Arctic White  
(Black Pattern/Volume Controllers)
- Natural Anodize  
(Black Pattern/Volume Controllers)
- Custom Color : \_\_\_\_\_

**SUPPLY MODELS**

- PJ-W1-150** 1-1/2" Slot Width (1-4 slots)

**RETURN MODELS** (No Internal Controllers)

- FFR-W1-150** 1-1/2" Slot Width (1-4 slots)

**OPTIONS**

- AD** Engineered Air Distribution Plenum
- LEC** Linear Egg Crate
- LED** Linear Equalizing Deflector

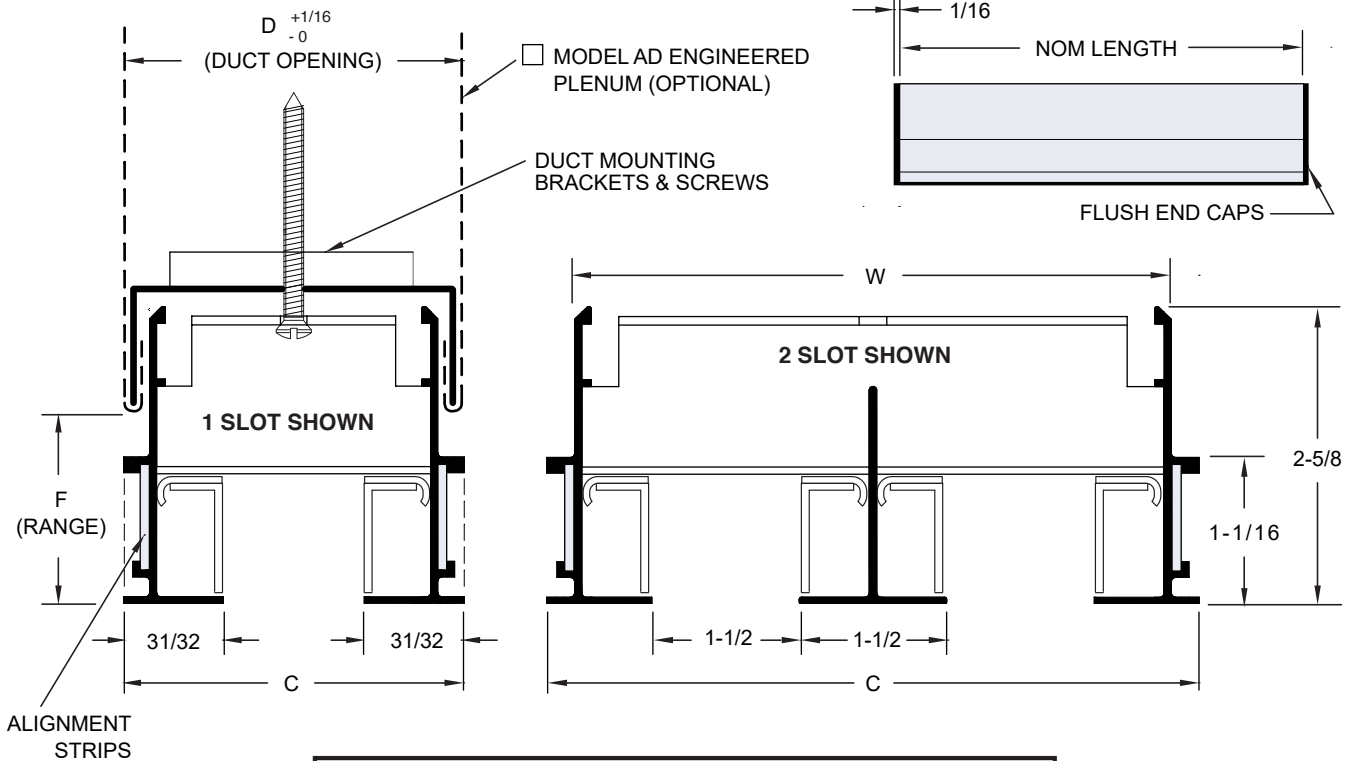

PJ-W1-150 • 1-1/2" SLOT WIDTH				
# SLOTS	W	C	D	F
1	3-1/16	3-7/16	3-5/16	1-25/32 to 2-5/32
2	6-1/16	6-7/16	6-5/16	
3	9-1/16	9-7/16	9-5/16	
4	12-1/16	12-7/16	12-5/16	

All dimensions are in inches.

**JOB NAME:**
**SUBMITTED BY:**