

SUBMITTAL SHEET

www.anemostat-hvac.com

1" SLOT WIDTH

FLUSH FRAME (W1)

PRODUCT FEATURES

- Adjustable volume and pattern controllers
- Flush mounting frame
- Hardware package includes duct mounting brackets & screws, and alignment strips (where applicable)
- Anemostat Model AD plenums are ordered and shipped separate from the diffusers
- Nominal Length is the order size
- Flush end caps are removable

CONSTRUCTION FEATURES

Material: Extruded Aluminum

Finish:

- Arctic White
(Black Pattern/Volume Controllers)
- Natural Anodize
(Black Pattern/Volume Controllers)
- Custom Color : _____

SUPPLY MODELS

- PJ-W1-100** 1" Slot Width (1-4 slots)

RETURN MODELS (No Internal Controllers)

- FFR-W1-100** 1" Slot Width (1-4 slots)

OPTIONS

- AD** Engineered Air Distribution Plenum
- LEC** Linear Egg Crate
- LED** Linear Equalizing Deflector

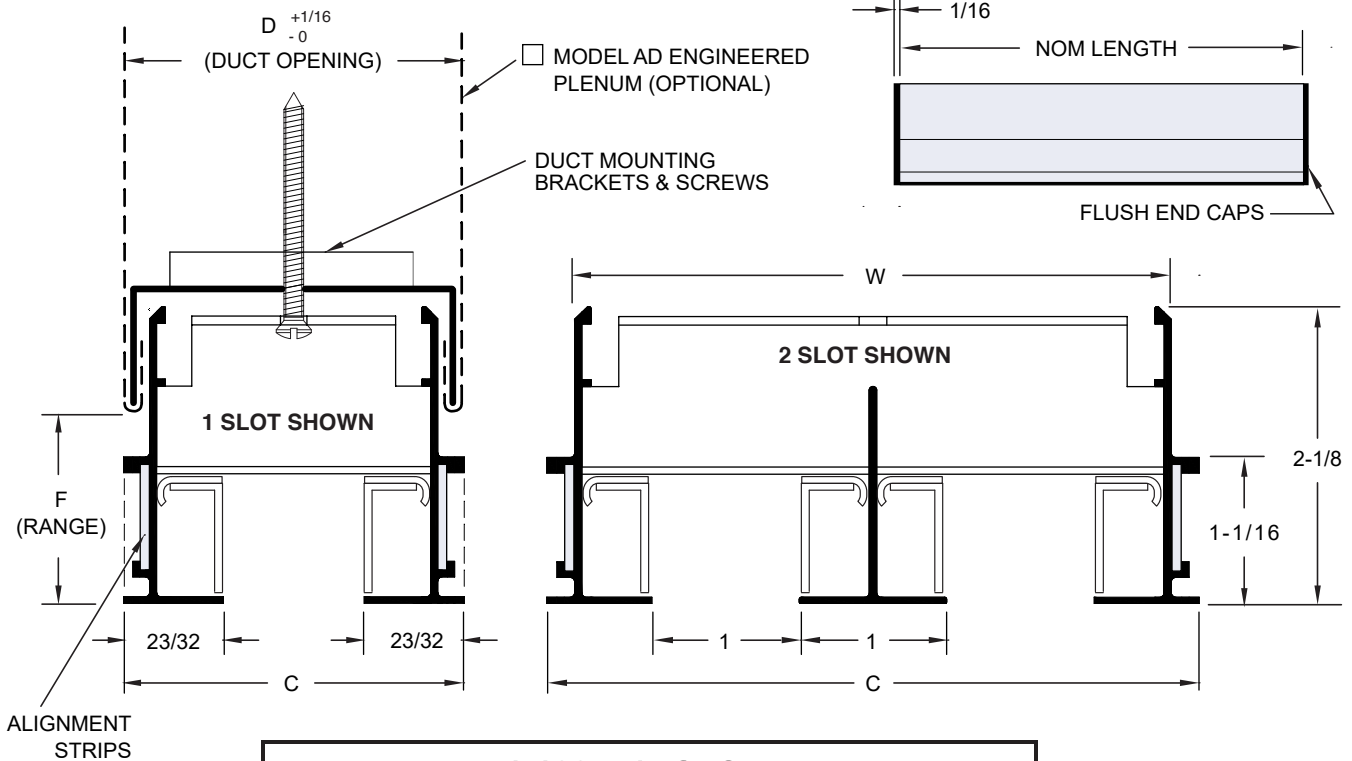

PJ-W1-100 • 1" SLOT WIDTH				
# SLOTS	W	C	D	F
1	2-1/16	2-7/16	2-5/16	1-5/16 to 1-11/16
2	4-1/16	4-7/16	4-5/16	
3	6-1/16	6-7/16	6-5/16	
4	8-1/16	8-7/16	8-5/16	

All dimensions are in inches.

JOB NAME:

SUBMITTED BY: