

SUBMITTAL SHEET

www.anemostat-hvac.com

HEAVY DUTY SECURITY GRILLE
FIXED LOUVERS • 3/4" SPACING

**LONG BLADES (L) & 0°
DEFLECTION SHOWN BELOW**

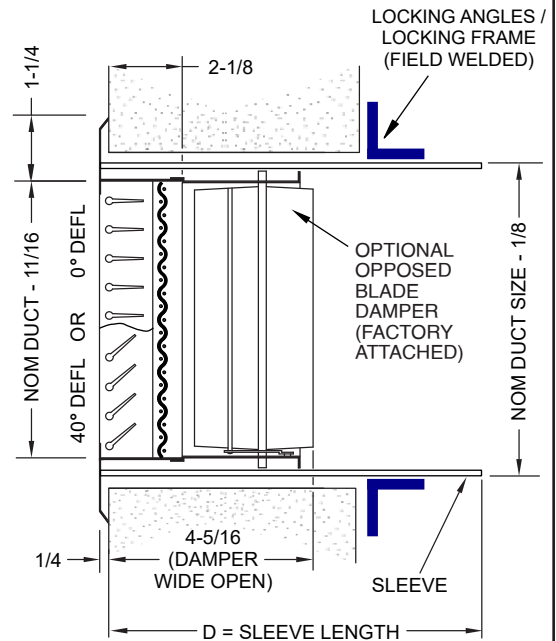
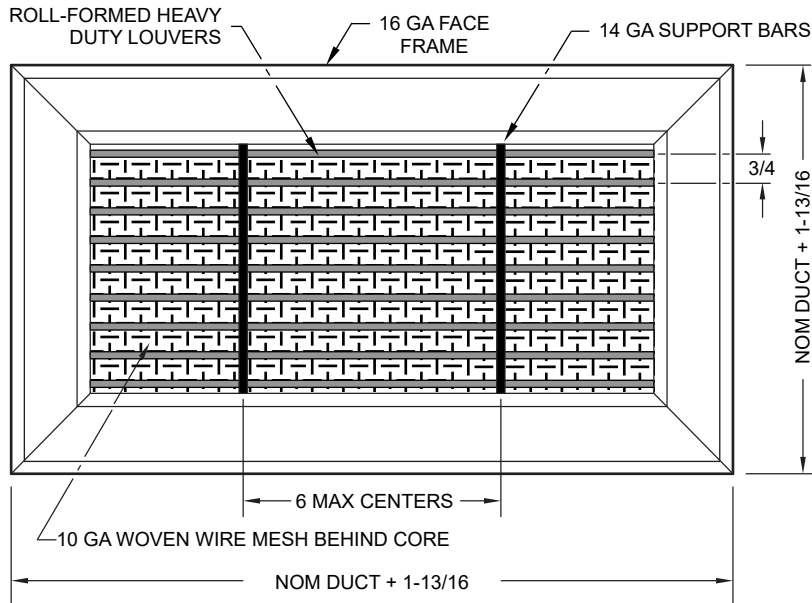

IMPORTANT: It is the specifier's responsibility to properly configure the HVAC system to meet the appropriate level of comfort, safety, security and detention

PRODUCT FEATURES

Face Frame

☐ 16 GA. (STANDARD) ☐ 14 GA.

Sleeve

☐ 14 GA. (STANDARD) ☐ 16 GA. ☐ 18 GA.
☐ Other

Fixed Louver Deflection Angle

☐ 0° Deflection ☐ 40° Deflection

Louver Direction (Based on W x H)

☐ Long (Louvers Parallel to Long Dimension)
☐ Short (Louvers Parallel to Short Dimension)
☐ NA (Square Sizes)

Woven Wire Mesh - 10 Ga

☐ 1/2" Square Holes on 5/8" Centers (STD)
☐ 3/8" Square Holes on 1/2" Centers

Material

☐ Plain Steel (STANDARD) ☐ Aluminum*
☐ 304 Stn Stl* ☐ 316 Stn Stl* ☐ Galvanized*
☐ Other

*(Consult factory for availability)

Finish

☐ **White Powder Coat (STANDARD)**☐ Rust-Inhibiting Primer☐ Other

Locking Angle (2 Pieces)

☐ 1" x 1" x 3/16" (STANDARD)

☐ 1-1/2" x 1-1/2" x 3/16" ☐ 2" x 2" x 3/16"

☐ Other

Locking Frame

☐ 1" x 1" x 3/16" (Optional)

☐ Other

OPTIONAL ACCESSORIES

☐ Model OB-1 Opposed Blade Damper - Front Operated

☐ Model OB-1 Opposed Blade Damper - Rear Operated

☐ Model SRA Square to Round Duct
(ships loose)

☐ Other Options (please specify)

All dimensions are in inches.

[illegible]

JOB NAME:

SUBMITTED BY: