



Anemostat®
AIR DISTRIBUTION

MODEL **SL410**

EXTRUDED ALUMINUM LOUVERS
4" DEEP

37° STRAIGHT BLADE-STATIONARY-CHANNEL TYPE

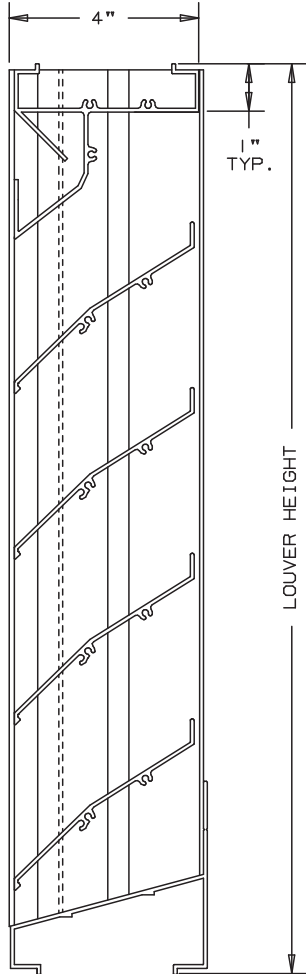

NOT TO SCALE

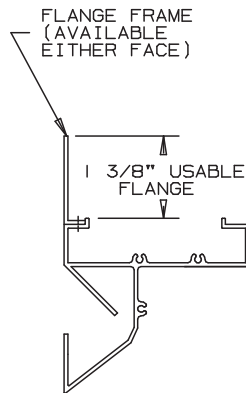
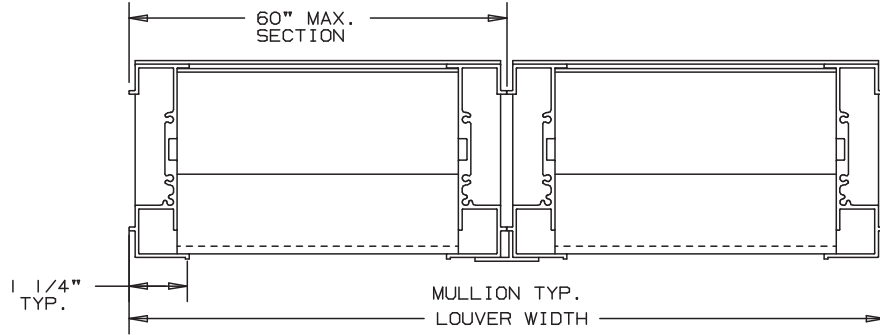

FLANGE FRAME
OPTION

SPECIFICATIONS

MATERIAL: EXTRUDED ALUMINUM 6063-T52/T6 ALLOY
AVAILABLE IN .081" THK. AND
.125" THK. (NOMINAL).
FACE OF LOUVER: FULL WIDTH SILL WITH HEAD AND
BLADES CONTAINED WITHIN JAMBS.
APPROXIMATE BLADE CENTERS 3 1/2".
SCREEN: (WHEN INDICATED, IN A REMOVABLE FRAME)
BIRD SCREEN - 1/2" FLATTENED ALUMINUM, .051" THK.
OR - 1/2" SQ. MESH INTERMEDIATE DOUBLE-
CRIMPED ALUMINUM WIRE, .063" DIA.
OR - 18/16 MESH, .011" DIA. ALUMINUM
WIRE INSECT SCREEN.

FINISH: _____

MINIMUM PANEL SIZE: 12" x 12"
MAXIMUM SINGLE PANEL SIZE: 60" x 96"

LOUVER PERFORMANCE STATEMENT

LOUVER MODEL SL410 SHALL BE FABRICATED TO PROVIDE
A MINIMUM OF (57%), 9.16 SQUARE FEET OF FREE AREA FOR
A 48" x 48" SIZE LOUVER AND BEAR THE AMCA CERTIFIED
RATINGS PROGRAM SEAL FOR AIR PERFORMANCE AND WATER
PENETRATION. THE RATING SHALL SHOW A BEGINNING
POINT OF WATER PENETRATION AT .01 OUNCES PER SQUARE
FOOT OF FREE AREA AT A FREE AREA VELOCITY OF 876
FEET PER MINUTE, (8024) CUBIC FEET PER MINUTE. WITH
.10 INCHES WATER GAUGE PRESSURE DROP FOR AIR INTAKE.

NOMINAL DEDUCTIONS WILL BE MADE TO THE OPENING SIZE GIVEN.

ITEM	QTY.	OPENING SIZE		LOUVER SIZE		MULL	SCREENS		UNION MADE
		WIDTH	HEIGHT	WIDTH	HEIGHT		TYPE	LOC	

Anemostat Air Distribution
1220 E. Watson Center Road
Carson, CA 90745
310-835-7500 • air@anemostat.com
www.anemostat-hvac.com

AGENT: _____

ARCH. /ENG. : _____

CONTR. : _____

PROJECT: _____

EDR: _____ ECN: _____ JOB: _____

DATE: _____ DWN. : _____ DWG. : _____

MODEL SL410

37° STANDARD BLADE

EXTRUDED ALUMINUM - STATIONARY

PERFORMANCE DATA

EXCELLENT WEATHER PROTECTION WITH LITTLE PRESSURE LOSS.
 TESTS OF A 48" X 48" SAMPLE BY AN AMCA ACCREDITED LABORATORY
 ACCORDING TO AMCA STANDARD 500 SHOWS LOW WATER PENETRATION.
 TESTS SHOW LESS THAN .02 OZ. PER SQ. FT. WATER PENETRATION AT
 900 FPM (FREE AREA VELOCITY) WITH LESS THAN .11" W.G. PRESSURE
 DROP (INTAKE).

RATINGS DO NOT INCLUDE THE EFFECT OF BIRDSCREEN.

PRESSURE DROP

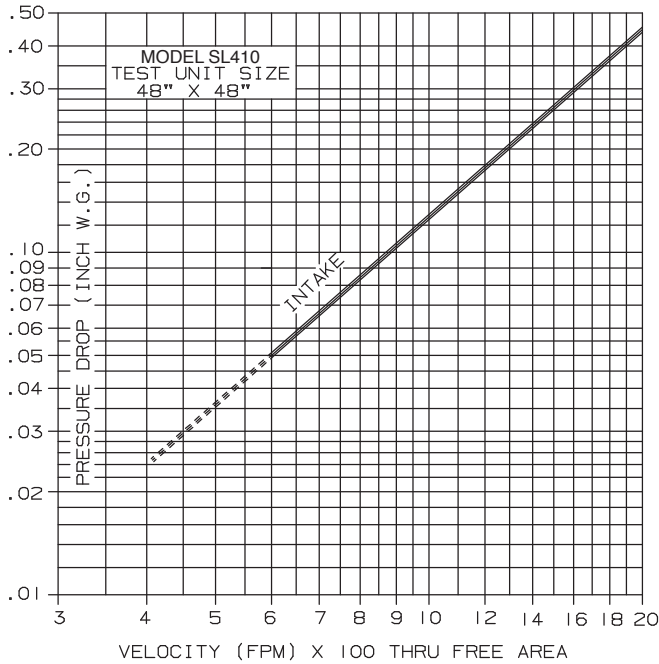

WATER PENETRATION

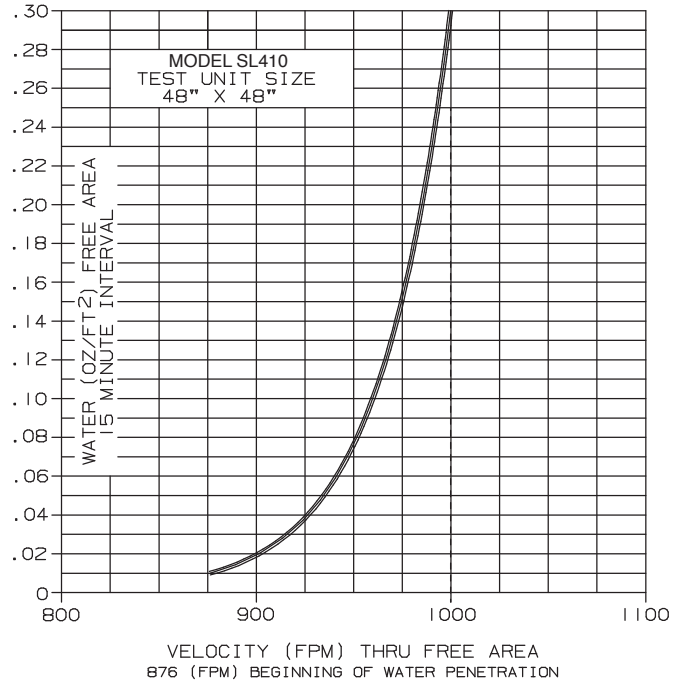

FREE AREA

HEIGHT	FREE AREA (SQ. FT.)									
	WIDTH									
	12"	18"	24"	30"	36"	42"	48"	54"	60"	
12"	.32	.53	.74	.94	1.15	1.35	1.56	1.76	1.97	
24"	.82	1.34	1.86	2.38	2.90	3.42	3.94	4.46	4.98	
36"	1.31	2.14	2.96	3.79	4.62	5.45	6.27	7.10	7.93	
48"	1.93	3.15	4.36	5.58	6.81	8.02	9.16	10.45	11.67	
60"	2.37	3.87	5.37	6.86	8.36	9.86	11.35	12.85	14.35	
72"	2.99	4.88	6.76	8.65	10.54	12.42	14.31	16.20	18.08	
84"	3.48	5.67	7.87	10.06	12.26	14.45	16.65	18.84	21.04	
96"	4.04	6.59	9.14	11.69	14.24	16.79	19.34	21.89	24.44	



Anemostat certifies that the performance data shown has been determined by test in accordance with applicable AMCA standards.



Anemostat®
AIR DISTRIBUTION

MODEL **SL410**

EXTRUDED ALUMINUM LOUVERS
CONTINUOUS LINE

37° STRAIGHT BLADE-STATIONARY-CHANNEL TYPE

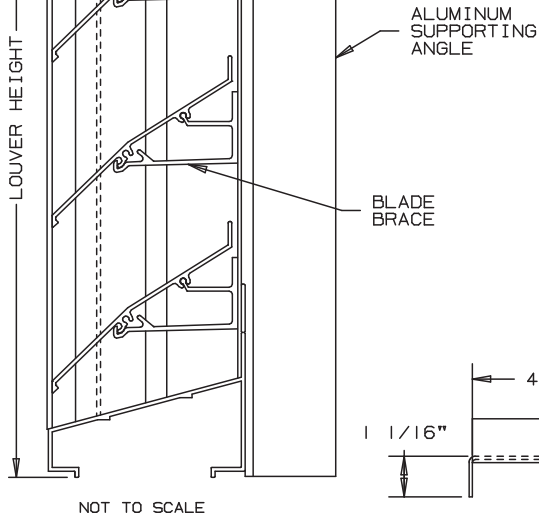
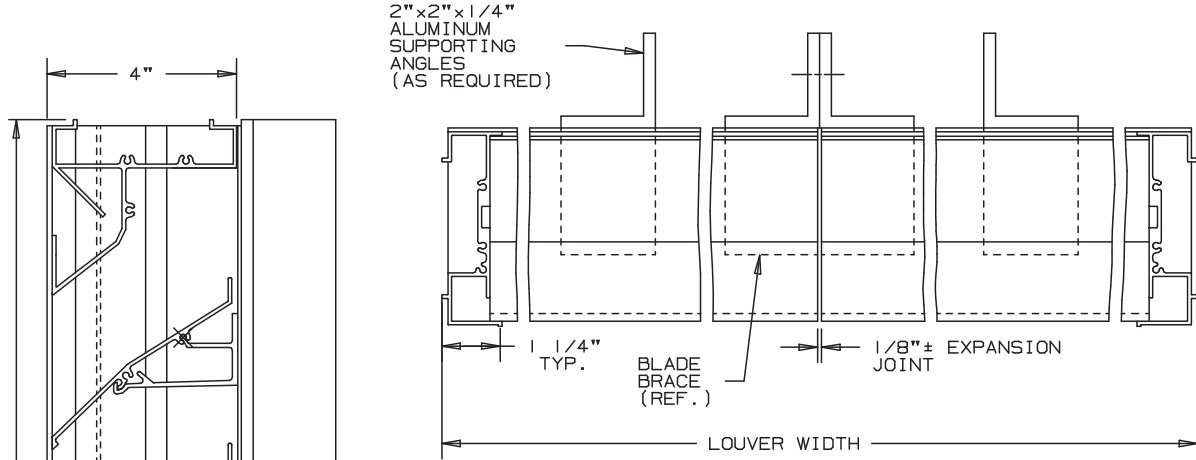

SPECIFICATIONS

MATERIAL: EXTRUDED ALUMINUM 6063-T52/T6 ALLOY
AVAILABLE IN .081" THK. AND
.125" THK. (NOMINAL).

FACE OF LOUVER: FULL WIDTH SILL WITH HEAD AND
BLADES CONTAINED WITHIN JAMBS.
APPROXIMATE BLADE CENTERS 3 1/2".

SCREEN: (WHEN INDICATED, IN A REMOVABLE FRAME)
BIRD SCREEN - 1/2" FLATTENED ALUMINUM, .051" THK.
OR - 1/2" SQ. MESH INTERMEDIATE DOUBLE-
CRIMPED ALUMINUM WIRE, .063" DIA.
OR - 18/16 MESH, .011" DIA. ALUMINUM
WIRE INSECT SCREEN.

FINISH: _____

LOUVERS SHALL WITHSTAND A WIND LOAD OF 20 PSF.
CONSULT FACTORY TO SUBSTITUTE OTHER LOAD REQUIREMENTS.

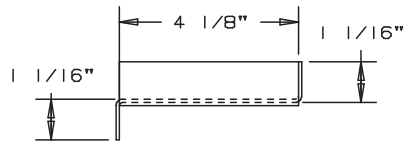

DRAIN PAN DETAIL

* A DRAIN PAN WILL BE PROVIDED
FOR HIDDEN MULLION ARCHITECTURAL
CONSTRUCTION FOR MULTI-SECTIONS IN
WIDTH (AS SHOWN ABOVE)

NOMINAL DEDUCTIONS WILL BE MADE TO THE OPENING SIZE GIVEN.

ITEM	QTY.	WIDTH	HEIGHT	WIDTH	HEIGHT	MULL	TYPE	LOC				
		OPENING SIZE		LOUVER SIZE			SCREENS					

Anemostat Air Distribution
1220 E. Watson Center Road
Carson, CA 90745
310-835-7500 • air@anemostat.com
www.anemostat-hvac.com

AGENT: _____

ARCH./ENG.:
CONTR.:
PROJECT:
EDR: _____ ECN: _____ JOB: _____
DATE: _____ DWN.: _____ DWG.: _____